

PART NO. 020-01-00159

CUSTOMER DRAWING

REVISIONS

LTR	DESCRIPTION	Drawing	DATE
AO	ease for ManufactureInitial Rel	JIANG	11/26'05
B	UPDATE DRAWING	Jun.L	09/26'07

NOTES:

- MATERIAL:
HOUSING: LCP+30%G/F, UL94V-0, COLOR: BLACK .
CONTACT: PHOSPHOR BRONZE C5191R-H,T=0.30±0.01mm.
- FINISH:
CONTACT: 15u" GOLD PLATING ON CONTACT AREAS;
100u" TIN PLATED ON SOLDER TAILS;
50u" NICKEL UNDERPLATE OVER ALL.
- PRODUCT SPECIFICATION REFERENCE TO *****.
- PACKAGING SPECIFICATION REFERENCE TO *****.

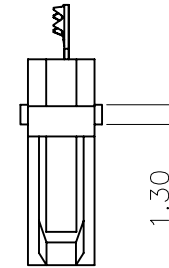
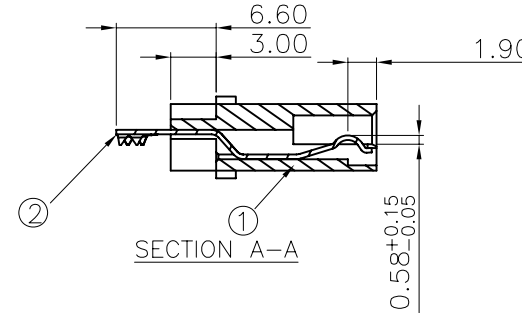
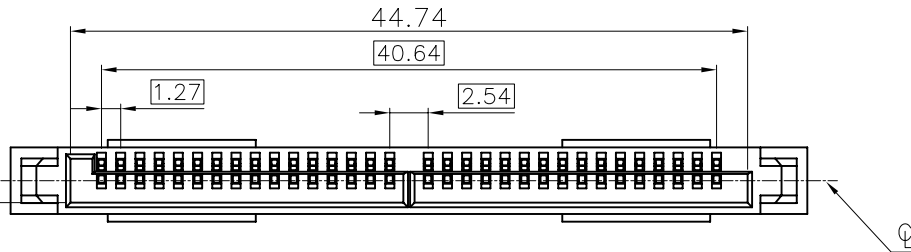
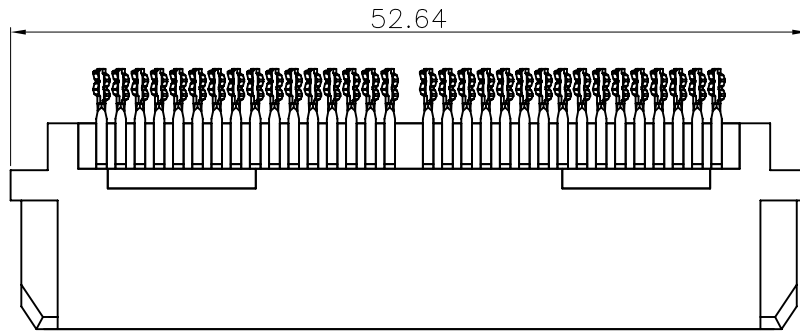
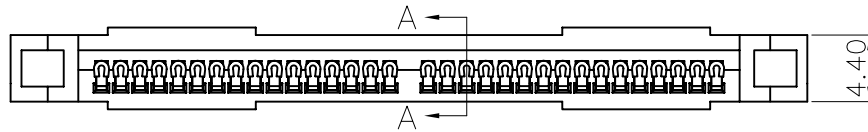
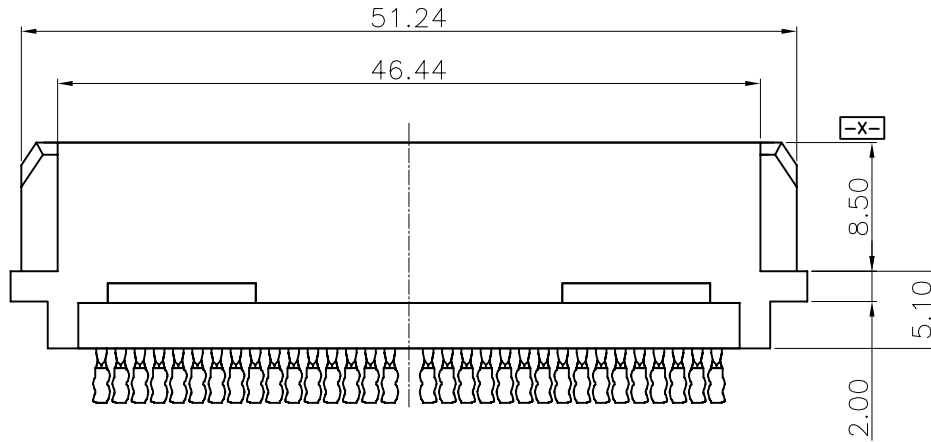

ITEM	DESCRIPTION	Q'TY	MATERIAL	FINISH
2	CONTACT	32	COPPER ALLOY	NI UNDERPLATING TIN PLATED ON SOLDER AREA GOLD PLATING ON CONTACT AREA
1	BASE	1	THERMAL PLASTIC	COLOR:BLACK

APPROVALS		DATE	PART NO. 020-01-00159			
DRAWN	Jun.L	09/26'07	TITLE: SAS 32P(SOCKET)CRIMPING TYPE(FOR SHELL) CUSTOMER DRAWING			
CHECKED			SIZE	SCALE :	DRAWING NO.	REV.
APPROVALS			mm	1 : 1	000281	B
DIMENSION ARE MILLIMETERS TOLERANCES ARE : DECIMALS .X iø 0.30 .XX iø 0.25 ANGLE: X ± 1°			ID NO.	XXXXXXXXXX	SHEET 1 OF 1	

DESCRIPTION

NO

Q'TY UNIT

DO NOT SCALE DRAWING

XXXXXXX

SHEET 1 OF 1