

1 2 3 4 5 6 7 8

| REV | MODIFICATION | DATE | DRAW |
|-----|--------------|------|------|
| | | | |
| | | | |
| | | | |

F
E
D
C
B
A

F
E
D
C
B
A

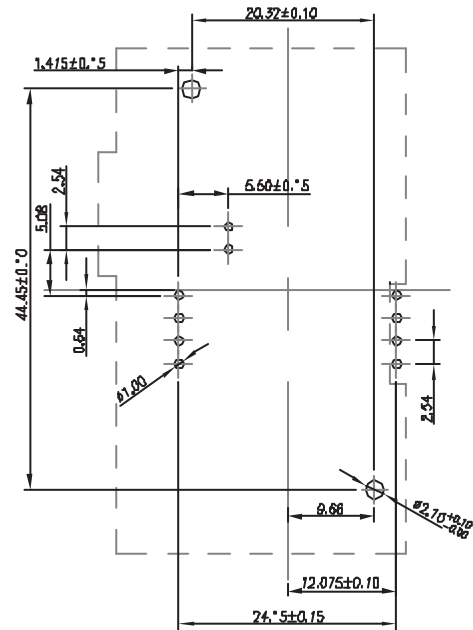
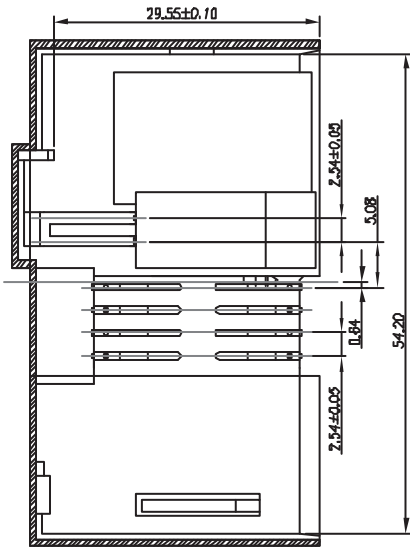
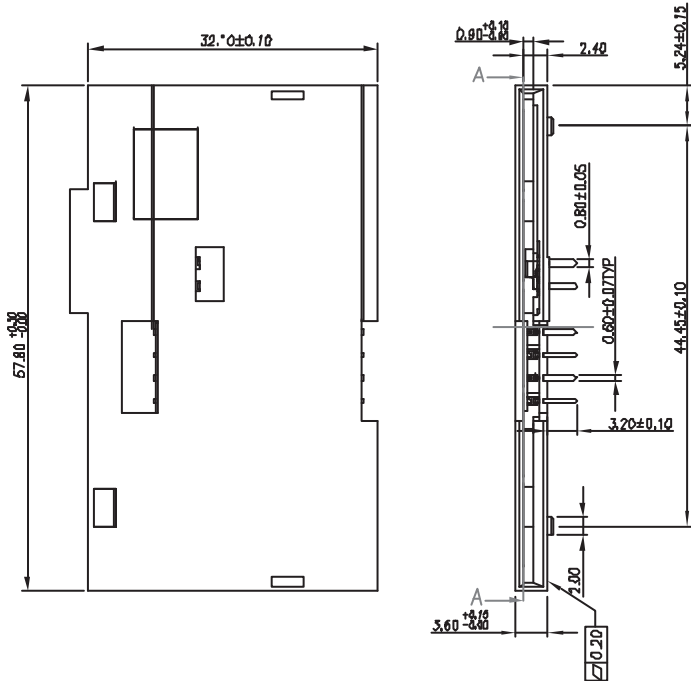
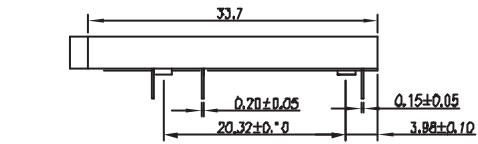

MATERIAL:
 COVER:THERMOPLASTIC, UL94V-0, BLACK
 HOSE:THERMOPLASTIC, UL94V-0, BLACK
 CONTACT:COPPER ALLOY, T=0.15mm
 SWITCH:COPPER ALLOY, T=0.20mm
 PLATING:
 CONTACT AREA-30u" GOLD OVER 50u" NICKEL
 RETENTION FORCE:0.30kg Min

ORDERING INFORMATION
 SMCRB-2 08 30 B102S
 PIN NO — PLATING

| | | | | |
|--------------------------------------|--------|-------------|--|--------------------------|
| DIMENSION IN mm [Inch] | | PROD. SPEC. | ALMITA CO., LTD. | |
| TOLERANCE UNLESS OTHERWISE SPECIFIED | | PKG. SPEC. | TITLE SCC LOW PROFILE DIP CUSTOMER DRAWING | |
| .X±0.30 | X'±3' | APPROVE | FILE NO. | DWG NO. SMCRB-20830B102S |
| .XX±0.20 | .X'±2' | CHECK | SIZE A4 | PROJ. SHEET 1 / 1 |
| .XXX±0.15 | .XX'± | DRAW | SCALE 1.2:1 | REV A |

1 2 3 4 5 6 7 8 8F-01-R10